

Ball Valves

Many options are available for this popular type of easy operation, full flow valve. These include manual, air or electrical activation. Standard non-hazardous valves are compliant to BS EN 12266 with ADR and stainless steel versions available to BS EN 14432.

Other key advantages of Molex Ball Valves include:

- Stainless steel Grade 316 ball as standard
- Cast iron ball optional
- Stainless Steel range optional
- Viton and PTFE seals optional
- Lockable handle open/closed
- Air or electrical activation available



Manual Ball Valves Spec

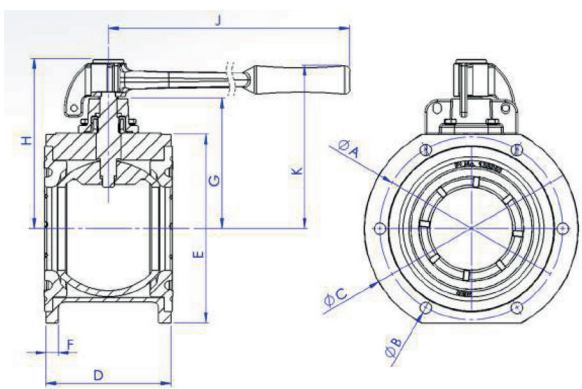

Size	1 1/2"	2"	3"	4"	6"
Pressure Rating	PN16	PN16	PN10	PN10	PN16
A	103	123	168	213	240
B	8.5	11	11	13.5	M20
No. of holes	4	4	6	6	8
C	SQ 90	SQ 107	205	250	300
D	61	70	121	146	210
E	SQ90	SQ 107	178	220	280
F	8.5	9	15	11.5	20
G	72	90	131	152	172
H	94	130	131	152	203
J	125	230	315	400	560
K	110	140	162	190	203
Weight(KG)	2.2	4	10	14	35

Air Operated Ball Valves Spec

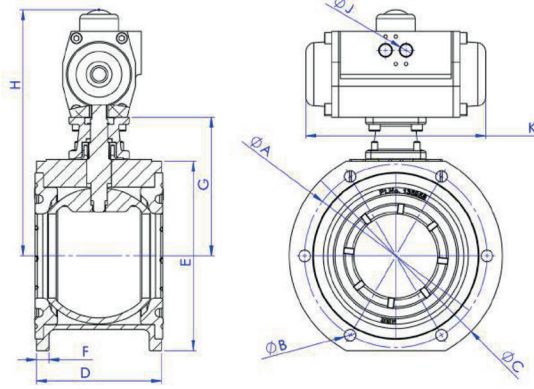

Size	2"	3"	4"	6"
Pressure Rating	PN16	PN10	PN10	PN16
A	123	168	213	240
B	8.5	11	13.5	M20
No. of holes	4	6	6	8
C	SQ 107	205	250	300
D	70	121	146	210
E	SQ 107	178	220	280
F	9	15	11.5	20
G	97	139	161	183
H	205	265	290	350
J(BSP)	1/4"	1/4"	1/4"	1/4"
K	150	205	205	305
Weight(KG)	4	12	16	40



Controlled Power to Deliver Efficiently





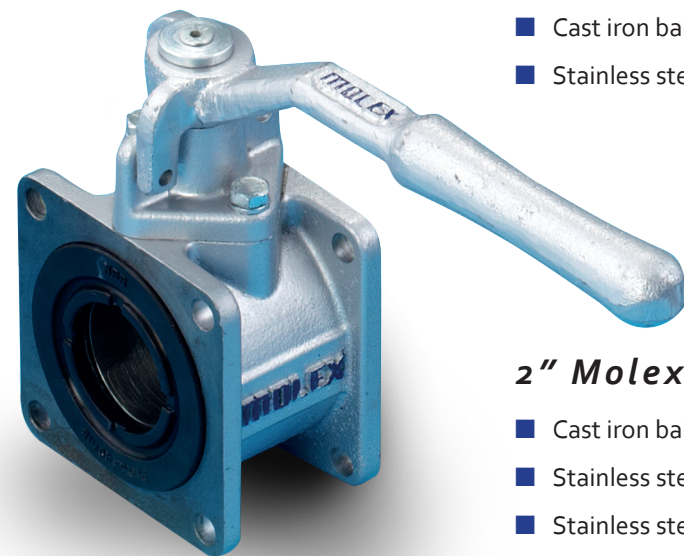

### 1 1/2" Molex Ball Valve

- Cast iron ball valve with NBR seals [Part Number 151590](#)
- Stainless steel valve with PTFE seals [Part Number 178341](#)

### 2" Molex Ball Valve

- Cast iron ball valve with NBR seals [Part Number 149766](#)
- Stainless steel valve with PTFE seals [Part Number 178341](#)
- Stainless steel valve with Viton seals [Part Number 149339](#)
- ADR valve with Viton seals [Part Number 167498](#)

### 3" Molex Ball Valve

- Cast iron ball valve with NBR seals [Part Number 150503](#)
- Stainless steel valve with PTFE seals [Part Number 164446](#)



### 4" Molex Ball Valve

- Cast iron ball valve with NBR seals [Part Number 147609](#)
- ADR valve with Viton seals [Part Number 148951](#)
- Stainless steel ball valve with Viton seals [Part Number 149235](#)
- Stainless steel ball valve with PTFE seals [Part Number 160446](#)



### 6" Molex Ball Valve

- Cast iron ball valve with PTFE seals [Part Number 150556](#)
- Stainless steel valve with PTFE seals [Part Number 150558](#)



### 1 1/2" Air Operated Molex Ball Valve

- Cast iron ball valve with NBR seals [Part Number 178352](#)

### 2" Air Operated Molex Ball Valve

- Cast iron ball valve with NBR seals [Part Number 154039](#)
- Stainless steel ball valve with Viton seals [Part Number 154043](#)

### 3" Air Operated Molex Ball Valve

- Cast iron ball valve with NBR seals [Part Number 154040](#)

### 4" Air Operated Molex Ball Valve

- Cast iron ball valve with NBR seals [Part Number 154041](#)
- ADR ball valve with Viton seals [Part Number 160524](#)
- Stainless steel ball valve with Viton seals [Part Number 154044](#)



### 6" Air Operated Molex Ball Valve

- Cast iron ball valve with PTFE seals [Part Number 154042](#)
- Stainless steel valve with PTFE seals [Part Number 150555](#)