



# ARCELLOR CONTROLS (INDIA)

REDEFINING INSTRUMENTATIONS

AN ISO 9001:2008, ISO 14001:2004 & OHSAS 18001:2007 CERTIFIED COMPANY

MFRS. : ALL TYPES OF IBR, NON IBR, PIPES, TUBES, HYDRUALICS, PNEUMATICS, INSTRUMENTATION VALVES & FITTINGS



WORLD LEADER IN PROCESS CONTROL TECHNOLOGY





# ARCELLOR CONTROLS (INDIA)

REDEFINING INSTRUMENTATIONS

AN ISO 9001:2008, ISO 14001:2004 & OHSAS 18001:2007 CERTIFIED COMPANY

## ABOUT US

ARCELLOR CONTROLS (INDIA) Offers wide range of instrumentation Fittings and Accessories for Process Industries and CEM'. These are manufactured at our state of art manufacturing facility and tested as per various national / international standards, ensuring Reliability, Consistency and Quality to our valuable customer.

## Our Manufacturing Programme :

### FITTINGS

- Compression Fitting
- Precision Pipe Fitting
- Hydraulic Fitting (DIN 2353/8434-1)
- 37DEC JIC-514/8434-2 Fitting (Flared Fitting)
- 10K/15K - Threaded Fitting
- 15K/20K - Adapter & Coupling

### VALVES

- Needle Valve
- Manifold
- Ball Valve
- Vent Valves
- Pressure Relief Valve
- Check Valve
- Gate / Globe Valves

### ACCESSORIES

- Air Header
- Condensate Pot
- Sampling Cylinder
- Thermowell
- Syphone
- Over Load Protector
- Pulsation Dampener
- Pipe Clamp
- S.S.,C.S.,A.S., Pipes & Tubes
- Pipe Flanges



# ARCELLOR CONTROLS (INDIA)

REDEFINING INSTRUMENTATIONS

AN ISO 9001:2008, ISO 14001:2004 & OHSAS 18001:2007 CERTIFIED COMPANY



## Precision Pipe Fitting

Threaded in-line pipe fittings are made of various material depending upon application, Taper threads provide self sealant. In parallel thread 'O' rings are recommended.

## Compression Tube Fitting

Gaugeability, Interchangeability and Corrosion resistance are the features of Arcellor Controls (India) Compression Tube Fittings, which provide a leak proof, torque free seal at all tubing connections in Instrumentation and Process Tubing.

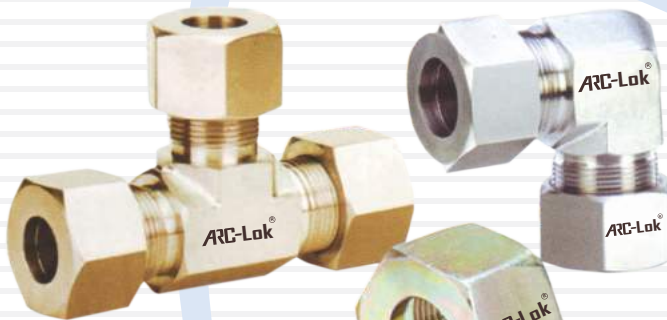
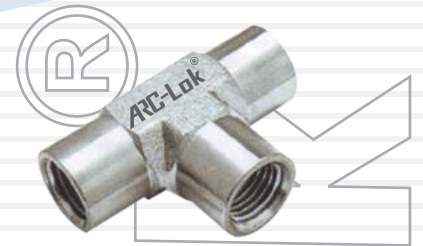

## Hydraulic Fitting (DIN 2353/8434-1)

Manufactured in accordance with DIN 2353 / DIN EN ISO 8434-1, available in stainless steel, carbon steel and brass



# ARCELLOR CONTROLS (INDIA)

REDEFINING INSTRUMENTATIONS

AN ISO 9001:2008, ISO 14001:2004 & OHSAS 18001:2007 CERTIFIED COMPANY

## 37° JIC-514/8434-Fitting (Flared Fitting)

Manufactured in accordance with SAE J514 / ISO 8434-2 standard available in stainless steel, carbon steel & brass



## 10K/15K - Threaded Fitting

A complete range of taper seal fittings are made of High tensile Ss316 stainless steel, to use upto 15,000 psi pressure



## 15K/20K - Adapter & Coupling

A complete range of cone end seal fittings are made of High tensile SS316 stainless steel to use upto 20,000 psi pressure





# ARCELLOR CONTROLS (INDIA)

REDEFINING INSTRUMENTATIONS

AN ISO 9001:2008, ISO 14001:2004 & OHSAS 18001:2007 CERTIFIED COMPANY



## Needle Valve

Made with Forged or Bar stock body, ARC-LOK Needle Valves are coupled with non-rotating stem, metal seating, soft packing, treated spindle. Fine threading of stem, large seat area, zero leak, precise and controlled resistance to flow, are the features of it. Designed to operate upto 20,000 psi.

## Manifold

Forged Construction, Arcellor Controls (India) Manifolds are designed and built to operate safely and reliably at pressures up to 6,000 psi. Single/Double bonnet design with 2, 3 and 5 way configuration are coupled with bubble fight shut-off and low torque operation.

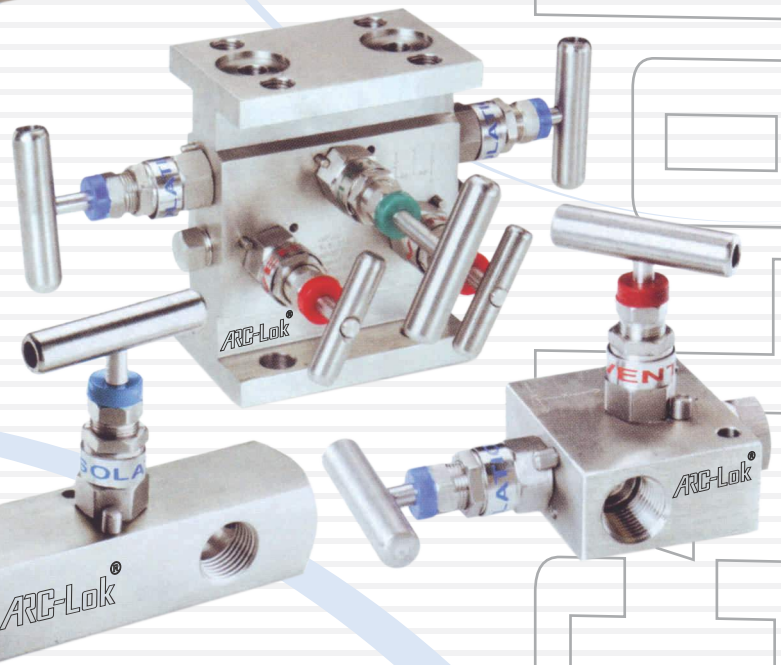

## Ball Valves

Manufactured in 2 and 3 piece design in various material construction with various end connection Available upto 10,000 psi marking pressure.

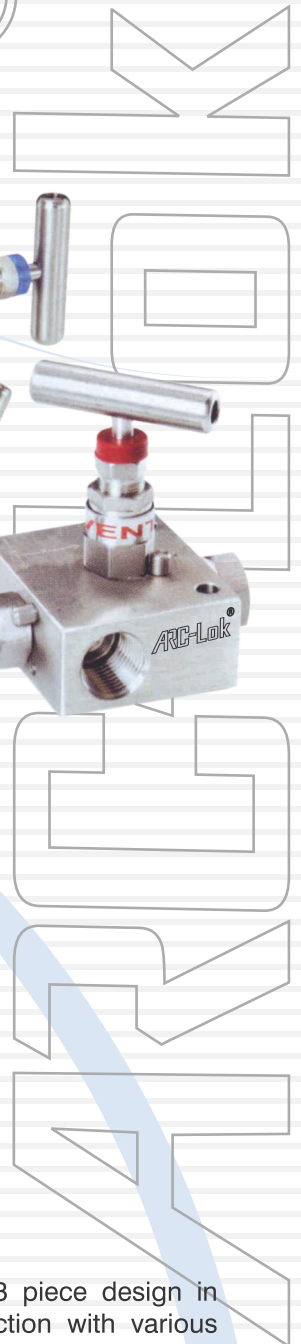



# ARCELLOR CONTROLS (INDIA)

REDEFINING INSTRUMENTATIONS

AN ISO 9001:2008, ISO 14001:2004 & OHSAS 18001:2007 CERTIFIED COMPANY

## Vent Valve

Available in stainless steel and carbon steel material of construction

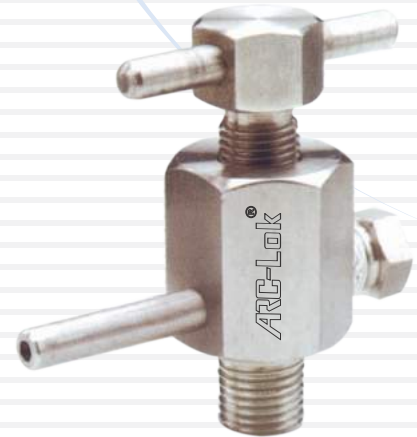

## Check Valve

Arcellor Controls (India) Non-Return Valve are designed with large orifice for maximum flow and low-pressure drop. These provide reliable operation of gases or liquids for set pressure upto 6,000 psi, with various material construction and cracking pressure.

## Globe & Gate Valve

M.O.C: SS 316L, SS 316, SS 304, A105, F91, F22

Size : 1/2" to 6"

End Conn. : SW/ NPT/ BSP/ BSPT

Pressure Range : 150#, 800#, 1500#, 2500#, 4500#



## Air Header

Manufactured in stainless steel and carbon steel with various end connections.

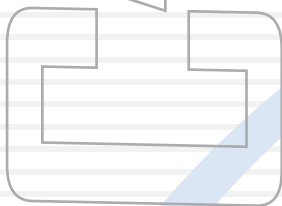

## Condensate Pot

Manufactured in stainless steel and carbon steel with various NB pipes of Sch 40/80.





# ARCELLOR CONTROLS (INDIA)

REDEFINING INSTRUMENTATIONS

AN ISO 9001:2008, ISO 14001:2004 & OHSAS 18001:2007 CERTIFIED COMPANY



## Sampling Cylinder

Available in stainless steel and carbon steel NB pipes of Sch 40/80 with various items capacity.

## Syphone

Manufactured from various NB pipes of Stainless Steel and carbon steel with various end connections in coil or 'U' type.

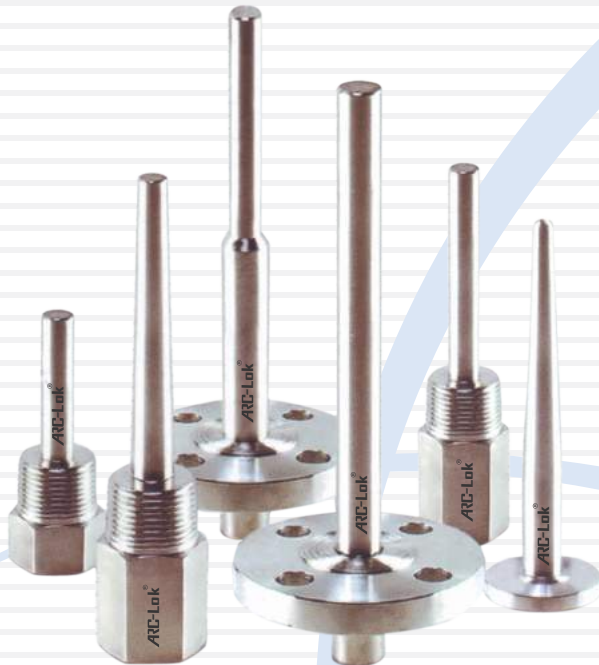
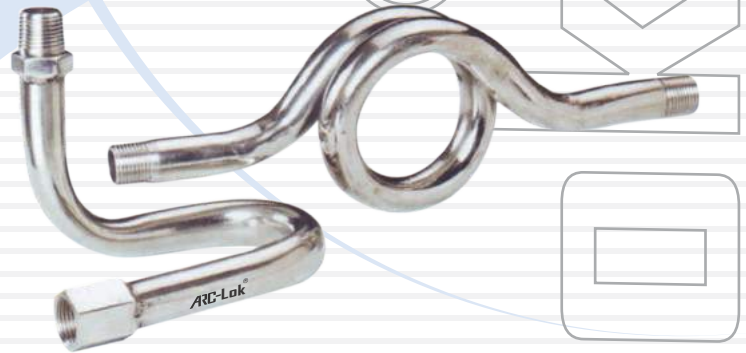

## Thermowell

Made in various MOC to suit application with fabricated or bar stock design having end connection as thread or flange and construction straight, tapered or stepped, Hydro Pneumatic test, good concentricity, radiography and ultrasonic test ensure reliable products.

## Over Load Protector

Protect pressure instrument from over pressure.



## Pipe Clamp

Single and double tube clamps in light and heavy duty for mounting tube.



## Pulsation Dampener

Reduce impact of process pulsation impact on pressure instrument.



ASME B 16.11-2001

FORGED FITTINGS.  
SOCKET-WELDING AND THREADED

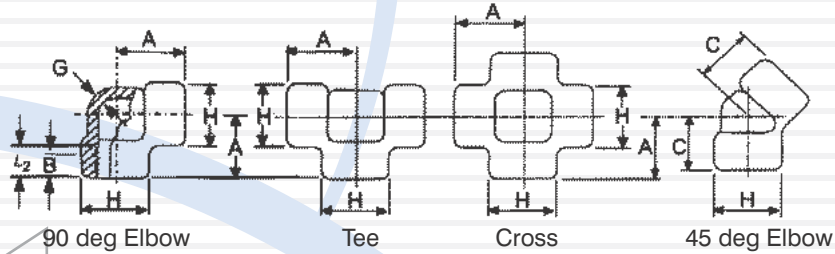

FORGED THREADED FITTINGS

DN	Nominal Pipe Size	Center-to-End Elbows, Tees, Crosses, A			Center-to-End 45 deg Elbow, C			Outside Diameter of Band, H			Min. Wall Thickness, G			Min. Length of Thread [Note(1)]	
		2000	3000	6000	2000	3000	6000	2000	3000	6000	2000	3000	6000	B	L <sub>2</sub>
6	1/8	21	21	25	17	17	19	22	22	25	3.18	3.18	6.35	6.4	6.7
8	1/4	21	25	28	17	19	22	22	25	33	3.18	3.30	6.60	8.1	10.2
10	3/8	25	28	33	19	22	25	25	33	38	3.18	3.51	6.98	9.1	10.4
15	1/2	28	33	38	22	25	28	33	38	46	3.18	4.09	8.15	10.9	13.6
20	3/4	33	38	44	25	28	33	38	46	56	3.18	4.32	8.53	12.7	13.9
25	1	38	44	51	28	33	35	46	56	62	3.68	4.98	9.93	14.7	17.3
32	1 1/4	44	51	60	33	35	43	56	62	75	3.89	5.28	10.59	17.0	18.0
40	1 1/2	51	60	64	35	43	44	62	75	84	4.01	5.56	11.07	17.8	18.4
50	2	60	64	83	43	44	52	75	84	102	4.27	7.14	12.09	19.0	19.2
65	2 1/2	76	83	95	52	52	64	92	102	121	5.61	7.65	15.29	23.6	28.9
80	3	86	95	106	64	64	79	109	121	146	5.99	8.84	16.64	25.9	30.5
100	4	106	114	114	79	79	79	146	152	152	6.55	11.18	18.67	27.7	33.0



GENERAL NOTE : Dimension are in millimeters  
NOTE:

(1) Dimension B is minimum length of perfect thread. The length of useful thread (B plus threads with fully formed roots and flat crests) shall not be less than L<sub>2</sub> (effective length of external thread) required by American National Standard for Pipe Threads (ASME B1.20.1), See Para. 6.3



### FORGED FITTINGS. SOCKET-WELDING AND THREADED

ASME B16.11-2001

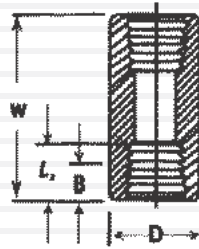

Coupling

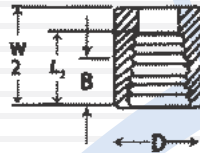

Half - Coupling

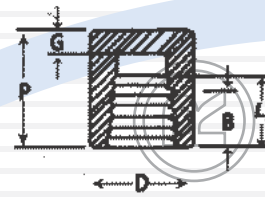

Cap

DN	Nominal Pipe Size	End - to - End Couplings, W		End - to - End Cops P		Outside Diameter, D		Min. End Wall Thickness, G		Min. Length of Thread [Note (1)]	
		3000	and 6000	3000	6000	3000	6000	3000	6000	B	L <sub>2</sub>
6	1/8	32		19	--	16	22	4.8	---	6.4	6.7
8	1/4	35		25	27	19	25	4.8	6.4	8.1	10.2
10	3/8	34		25	27	22	32	4.8	6.4	9.1	10.4
15	1/2	48		32	33	28	38	6.4	7.9	10.9	13.6
20	3/4	51		37	38	35	44	6.4	7.9	12.7	13.9
25	1	60		41	43	44	57	9.7	11.2	14.7	17.3
32	1 1/4	67		44	46	57	64	9.7	11.2	17.0	18.0
40	1 1/2	79		44	48	64	76	11.2	12.7	17.8	18.4
50	2	80		48	51	76	92	12.7	15.7	19.0	19.2
65	2 1/2	92		60	64	92	108	15.7	19.0	23.6	28.9
80	3	102		65	68	108	127	19.0	22.4	25.9	30.5
100	4	121		68	75	140	159	22.4	28.4	27.7	33.0



Coupling

Half - Coupling

Cap

#### GENERAL NOTES :

- a) Dimensions are in millimeters.
- b) Class 2000 and DN6 Class 6000 couplings, half couplings, and caps are not included in this Standard.

#### Note:

(1) Dimension B is minimum length of perfect thread. The length of useful thread (B plus thread with fully formed roots and flat crests) shall not be less than L<sub>2</sub>(effective length of extranal thread) required by American National Standard for Pipe Threads (AME B1.20.1) See Para. 6.3)

ASME B16.11-2001

FORGED FITTINGS.  
SOCKET-WELDING AND THREADED

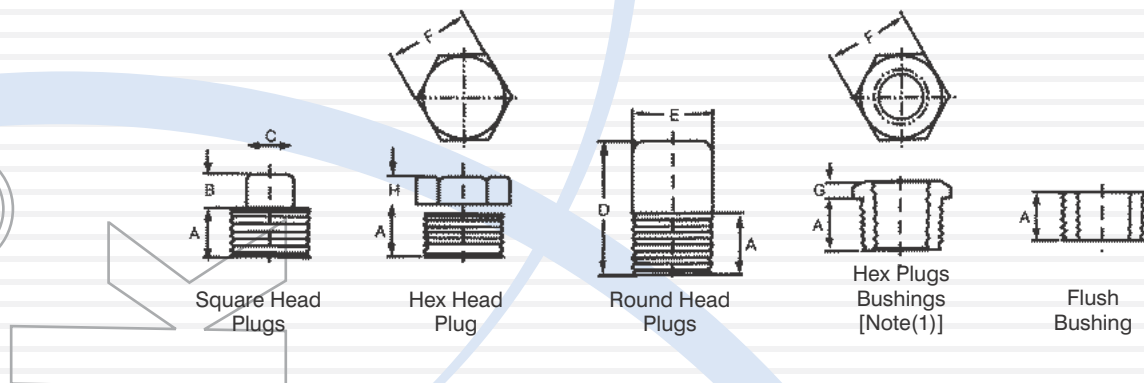

### PLUGS AND BUSHINGS

DN	Nominal Pipe Size	Min Length A	Square Head Plugs		Round Head Plugs		Hex Plugs and Bushings		
			Min Square Height B	Min Width Flats C	Nominal Head Diameter, E	Min Length D	Nominal Width Flats, E	Min. Hex Height	
								Bushing G	Plug H
6	1/8	10	6	7	10	35	11	---	6
8	1/4	11	6	10	14	41	16	3	6
10	3/8	13	8	11	18	41	18	4	8
15	1/2	14	10	14	21	44	22	5	8
20	3/4	16	11	16	27	44	27	6	10
25	1	19	13	21	33	51	36	6	10
32	1 1/4	21	14	24	43	51	46	7	14
40	1 1/2	21	16	28	48	51	50	8	16
50	2	22	18	32	60	64	65	9	18
65	2 1/2	27	19	36	73	70	75	10	19
80	3	28	21	41	89	70	90	10	21
100	4	32	25	65	114	76	115	13	25

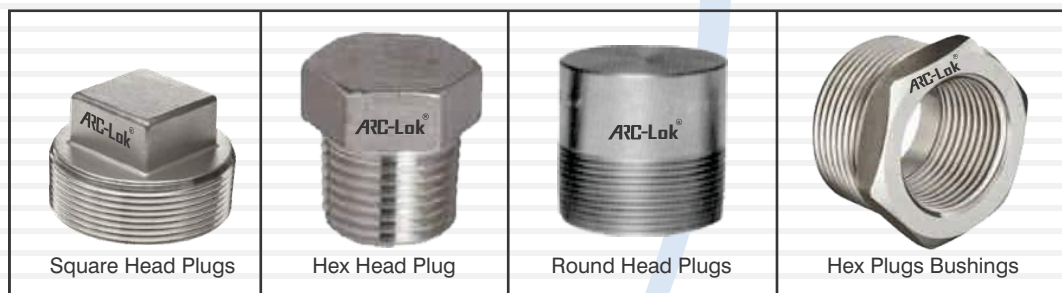

GENERAL NOTES : a) Dimensions are in millimeters.

Note:

(1) Cautionary Note Regarding Hex Bushings : Hex head bushings of one-size reduction should not be used in services where they might be subject to harmful loads and forces other than internal pressures.



# ARCELLOR CONTROLS (INDIA)

## REDEFINING INSTRUMENTATIONS

### AN ISO 9001:2008, ISO 14001:2004 & OHSAS 18001:2007 CERTIFIED COMPANY

#### Stainless Steel :

ASTMA182 F304/304L/304H/316/316L/317/317L/321/310 347/904 etc.

#### Carbon Steel :

ASTMA105/A694/F42/46/52/56/60/65/70/A350 LF3/A350 LF2, etc

#### Alloy Steel :

ASTM 182 F1/F5/F9/F11/F22/F91 etc

#### Types :

Weld neck, Slip-on (SORF), Blind, Socket Weld, Lap joint, Spectacles, Ring joint, Orifice, Long Weld neck Deck Flange, etc.

#### Size :

1/4" NB TO 24" NB

#### Class :

150#, 300#, 600# 900#, 1500# & 2500#

### FLANGES



#### Stainless Steel :

TP 304/304L/304H/316/316L/317/317L/321/310/347/904L/Seamless/ERW/square rectangular/pipe etc.

#### Carbon Steel :

ASTMA 53 GR. B/A 106 GR. B/ API 5L GRADE B/API 5L GR. X42/46/52/56/60/65/70/A333 GR. 3/GR. 6/BS 3059 etc.

#### Alloy Steel :

ASTMA335 GR. PI/P5/P9/P11/P22/P91/IS 1239 Light (A Class / Medium (B Class) / Heavy (C Class) / IS 3589

#### Types :

Round, Square, Rectangular.

Size: upto 24" NB. (Seamless & Welded)

Wall Thickness : Sch. 5 to Sch. XXS

### TUBES / PIPES



#### Stainless Steel :

ASTMA403 WP304/304L/304H/316/316L/317/317L/321/310/347/904L etc.

#### Carbon Steel :

ASTMA234 WPB/A420 WPL3 A420 WPL6 MSS-SP-75 WPHY 42/46/52/56/60/65/70

#### Alloy Steel :

ASTMA234 WP1/WP5/WP9/WP11/WP22/WP91 etc

#### Types :

Elbow, Tee, Reducer, Return Bends, Stub- Ends caps Collar, Cross, Insert etc.

#### Size :

1/4" NB TO 32" B (Seamless & Welded)

Wall Thickness : Sch. 5 to Sch. XXS

### BUTT WELD FITTING





# ARC-LOK



## ARCELLOR CONTROLS (INDIA)

AN ISO 9001:2008, ISO 14001:2004 & OHSAS 18001:2007 CERTIFIED COMPANY

### REDEFINING INSTRUMENTATIONS

**Mfrs & Exporters of Hydraulic, Pneumatics,  
Instrumentations Valves & Fittings & All Types of Pipes, Tubes**

85-B1, Icol Estate, Opp. Kesarsingh Estate, Near Kewal Kanta Char Rasta,  
Gujarat Bottling Road, Rakhial, Ahmedabad - 380 023.

**Tel. : 079-2273 3345 / 2273 3346 • Mob. : 96197 40004 / 96194 40004**

**E-mail : [arcellorcontrols@gmail.com](mailto:arcellorcontrols@gmail.com) , [arclok@yahoo.in](mailto:arclok@yahoo.in)**

**Web. : [www.arcellorcontrols.com](http://www.arcellorcontrols.com) / [www.tubesfitting.com](http://www.tubesfitting.com)**

India Branches Office : AHMEDABAD, MUMBAI, BANGALORE, CHHATTISGARH,  
Overseas Branches Office: CANADA , USA

